

4

3

2

1

ITEM NO.	PART NUMBER	DESCRIPTION	VENDOR	PRICE	QTY.
1	JB-BRKT-MNT	MOUNTING BRACKET	MACHINE SHOP	\$40.00	1
2	VSS10FLPB	TEE HINGE	ADJUSTABLELOCKINGTECH.COM	\$93.00	1
3	.25 FLAT WASHER	1/4-20 FLAT WASHER		\$3.00	5
4	.25 STAR LOCK WASHER	1/4-20 STAR LOCK WASHER		\$6.00	15
5	1/4-20 UNC-2B X .750L	1/4-20 X .750 HEX HEAD BOLT		\$10.00	5
6	JB-BACKPLT	HOLDER BACKPLATE	MACHINE SHOP	\$40.00	1
7	JB-FRNTPLT	HOLDER FRONT PLATE	MACHINE SHOP	\$80.00	1
8	6NZY2	10-32 X 1.5" HEX STANDOFF	GRAINGER.COM	\$25.00	8
9	.19 FLAT WASHER	10-32 FLAT WASHER		\$3.00	4
10	.19 STAR WASHER	10-32 STAR LOCK WASHER		\$10.00	4
11	10/32 UNF-2B X .875L	10-32 X .875 HEX HEAD BOLT		\$8.00	4
13	VAL10PB	STRAIGHT HINGE	ADJUSTABLELOCKINGTECH.COM	\$90.00	1
15	JB-HEAD	CAMERA HOLDER HEAD	MACHINE SHOP	\$60.00	1
16	JB-SHORT	SHORT END PIPE	MACHINE SHOP	\$40.00	1
17	BALLHEAD SLR-ZOOM	BALLHEAD CAMERA MOUNT	JOBY.COM	\$40.00	1
19	IV-500CA	MONOCHROME CAMERA	KEYENCE.COM	N/A	1
23	JB-T-HINGE	T-HINGE PIPE	MACHINE SHOP	\$60.00	1
24	JB-STRAIGHT	STRAIGHT HINGE PIPE	MACHINE SHOP	\$60.00	1
25	JB-ADJUST	ADJUSTER PIPE	MACHINE SHOP	\$60.00	1
26	1/4-20 UNC-2B X .500L	1/4-20 X .500 HEX HEAD BOLT		\$12.00	6
27	.250 NARROW FLAT WASHER	1/4-20 NARROW FLAT WASHER		\$5.00	14
28	1/4-20 UNC-2B X 1.375L	1/4-20 X 1.375 HEX HEAD BOLT		\$8.00	4
29	1/4-20 HEX NUT	1/4-20 HEX NUT		\$4.00	4

NOTES:

1. APPROXIMATE TOTAL COST = \$700.00
2. BOLTS ESTIMATED AT \$2.00 EACH
3. TUBES AND PLATES RAW STOCK ORDER FROM ONLINEMETALS.COM
4. TUBES AND PLATES MACHINED PARTS ESTIMATED AT \$60/HR

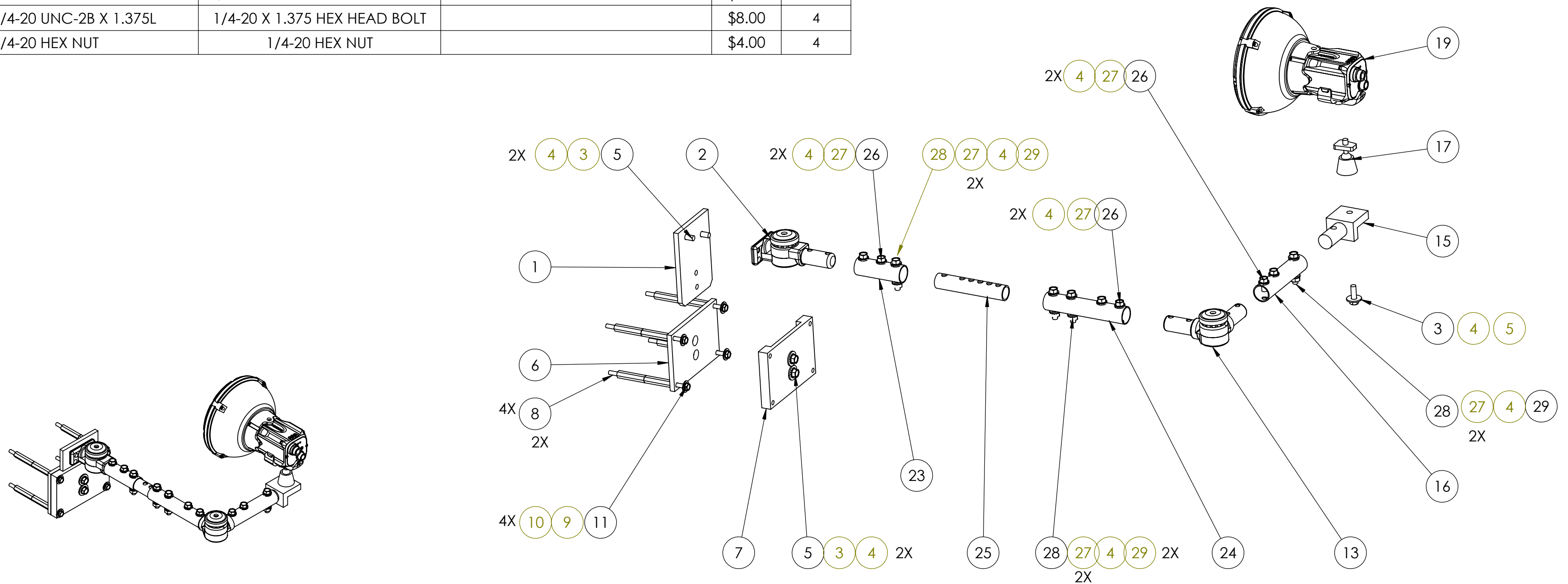

JILIA

PROPRIETARY AND CONFIDENTIAL
 THE INFORMATION CONTAINED IN THIS DRAWING IS THE SOLE PROPERTY OF <INSERT COMPANY NAME HERE>. ANY REPRODUCTION IN PART OR AS A WHOLE WITHOUT THE WRITTEN PERMISSION OF <INSERT COMPANY NAME HERE> IS PROHIBITED.

UNLESS OTHERWISE SPECIFIED:		NAME	DATE
DIMENSIONS ARE IN INCHES		DRAWN	J. BURES 12/17/16
TOLERANCES:		CHECKED	
FRACTIONAL ±		ENG APPR.	
ANGULAR: MACH ± BEND ±		MFG APPR.	
TWO PLACE DECIMAL ±		Q.A.	
THREE PLACE DECIMAL ±		COMMENTS:	
INTERPRET GEOMETRIC TOLERANCING PER:		THIRD ANGLE PROJECTION	
MATERIAL			
FINISH			
APPLICATION			

Team JLA Incorporated		
TITLE: CAMERA ARM ASSEMBLY		
SIZE	DWG. NO.	REV
C	AX-TopLevel	1
SCALE: 1:4	WEIGHT:	SHEET 1 OF 1

4

3

2

1